

Public Interest Incorporated Foundation Nitōri International Scholarship Foundation
Scholarship Program for International Students Coming to Japan in FY2026
Application Guidelines for JST Sakura Science Club Member Recommendation Slot

The Nitōri International Scholarship Foundation (hereinafter referred to as "the Foundation") has established a special recommendation slot for members of the JST Sakura Science Club under its FY2026 scholarship program for international students coming to Japan (hereinafter referred to as "the Scholarship"). In response, JST will conduct a selection process to recommend candidates to the Foundation as outlined below.

For details about the Foundation, please refer to the pamphlet (in English) and the website (in Japanese):

Pamphlet: https://www.nitori-shougakuzaidan.com/wp-content/themes/shougakuzaidan/pdf/pamphlet2024_en.pdf

Website: <https://www.nitori-shougakuzaidan.com/>

1. Scholarship Overview

Nitōri International Scholarship Foundation Scholarship Program for International Students Coming to Japan in FY2026

JST Sakura Science Club Member Recommendation Slot

1. **Scholarship Amount:** ¥80,000 per month (grant-type, no repayment required)
2. **Duration:** April 2026 – March 2027
 - For students graduating during the scholarship period, support ends in the month of graduation.
 - Renewable annually up to the standard duration of study, subject to review. Continuation may be denied in cases of poor academic performance etc.
3. **Payment Method:** Monthly
 - For students who have been in Japan for less than 6 months: sent via registered mail.
 - For students who have been in Japan for 6 months or more: transferred to a bank account.
 - Paid directly by the Foundation.
 - First payment in June 2026 (includes April and May).

4. **Number of Recipients:** Up to 50 students

Additionally, female students may apply for a women-only dormitory operated by the Foundation in Tokyo. If you wish to apply for dormitory accommodation, please indicate your preference in the application form. The result of the dormitory application will be notified together with the outcome of the scholarship selection.

For details, please refer to the attached document of this application guideline.

2. Eligibility Criteria

Applicants must meet **all** of the following conditions as of the end of April 2026:

1. Program Participation:

- Must have participated in the Sakura Science Exchange Program (via open call or direct invitation).
- Eligible nationalities: India, Indonesia, Malaysia, the Philippines, Singapore, and Thailand (alphabetical order).
- Participation in online-only programs is **not** eligible.
- If you do not meet this criterion, you may still be eligible to apply directly to the Foundation. Please check the Foundation's website for details.

2. Visa Status: Student visa

3. Type of Study: Self-financed study abroad

4. Age, Academic Level, and Enrollment Status:

- **Undergraduate (4-year programs):** Age 30 or younger, enrolled or planning to enroll as a full-time student in years 1–4 at a Japanese university in FY2026.
- **Undergraduate (6-year programs):** Age 30 or younger, enrolled or planning to enroll as a full-time student in years 1–6 at a Japanese university in FY2026.
- **Graduate (Master's programs):** Age 30 or younger, enrolled or planning to enroll as a full-time student in years 1–2 of a master's program at a Japanese university in FY2026.

5. Academic Performance:

- GPA of 2.5 or higher (on a 4.0 scale) from university entrance to present.
- If university grades are not yet available, a GPA of 3.5 or higher (on a 5-point scale) from the final year of high school is recommended.

3. Conditions for Receiving the Scholarship

1. Concurrent Scholarships:

- Total monthly amount including other scholarships must not exceed ¥150,000

2. Requirements for Receiving the Scholarship:

Must meet all of the following conditions:

(a) Reside in Japan

(b) Submission of the Following Documents

- Residence card (Zairyū Shikaku-shō)
- Document verifying current residential address
- Bank account information

(c) Submit a report (approx. 400 characters) every two months as specified by the Foundation

- Must meet deadlines
- Written in English or Japanese

- (d) Participate in an annual exchange event hosted by the Foundation

4. Application Method and Selection Schedule

1. Application Period:

- Wednesday, November 26, 2025 – Tuesday, February 10, 2026

2. How to Apply:

- Fill out the application form via the website.
 - An application number will be issued upon submission.
 - Application Form: https://www.jistec.or.jp/ssc/scholarship_form.html
- Upload required documents via the designated site:
 - Document Submission:

<https://jistec1990.sharepoint.com/:f:/s/submit/IgCJCE8R4b1bQI9mGFtuhsTXAXku14x2XI25xwQ9rqx8q80>

- Late submission of certain documents (e.g., admission letters) may be accepted until March 18 **only if prior notice is given.**

✧ **Required Documents:**

Submission	File Naming Convention for Submission please name each file using the following format: [Your 4-digit application number]_[Document code]
facial photograph	For example: 1234_01
Proof of enrollment/admission ※ Student ID cards are not accepted	For example: 1234_02
Passport page with entry stamp	For example: 1234_03

✧ **Optional Documents:**

Submission	File Naming Convention for Submission please name each file using the following format: [Your 4-digit application number]_[Document code]
Letter of recommendation from academic advisor	For example: 1234_04
Supplementary documents on financial situation	For example: 1234_05
Other documents	For example: 1234_06

3. Notification of Results:

- Notification of Selection Results: April 2026
- Final selection and decision will be made by the Foundation based on JST's recommendation

4. Important Notes:

- Incomplete applications or missing documents may result in disqualification.
- Late applications or document submissions will not be accepted to ensure fairness.
- JST may request interviews for selected applicants:
 - Period: February 24 (Mon) – March 19 (Wed), 2026
 - Format: Online interview (15–30 minutes)
- All applicants will be notified of the results, regardless of outcome.
- Inquiries regarding selection results will not be accepted.
- Applicants may also apply directly to the Foundation's scholarship program but cannot be selected for both simultaneously.

5. Handling of Personal Information

Personal information provided during the application process will be used solely for application processing, selection, and notification purposes. Some of these tasks will be carried out by the Japan International Science and Technology Exchange Center (JISTEC), commissioned by JST. All personal information will be appropriately managed in accordance with JST's Personal Information Protection Policy (<https://www.jst.go.jp/kojin/bunsyo/kisoku.pdf>) and will not be used for any other purposes. JISTEC and other parties involved will also manage the information appropriately under JST's instructions.

【Inquiry on scholarship application: ssc20@jistec.or.jp】



Overview	Women's Dormitory / Fee:30,000 yen ・ (includes gas and Wi-Fi)
Nearest Station	Toei Mita Line, Nishi-dai Station, about 5 min. on foot
Structure	Reinforced concrete, 4 storie(built in 1985, renovated in 2022) /40 rooms
Room Layout	One-room, approx. 14㎡
Facility Features	Auto-lock / Security cameras / Bicycle parking / Delivery box / Shared lounge
Room Equipment	<ul style="list-style-type: none"> ■ Bed / Mattress / Desk / Chair / Curtain ■ Air conditioner / Refrigerator / Washing machine / TV / Microwave / Lighting
Surroundings	Convenience store: 4 min. / Supermarket: 5 min. / Drugstore: 3 min. (on foot)
Access to University	<ul style="list-style-type: none"> ・ University of Tokyo, Hongo Campus: 23min. to Kasuga Station ・ Meiji University, Surugadai Campus: 27min. to Jimbocho Station ・ Rikkyo University, Ikebukuro Campus: 30min. to Ikebukuro Station

*Breakdown of the 30,000 yen fee: 25,000 yen for dormitory fee and 5,000 yen for common service fee (including gas and Wi-Fi).

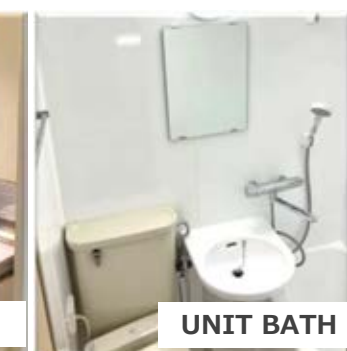
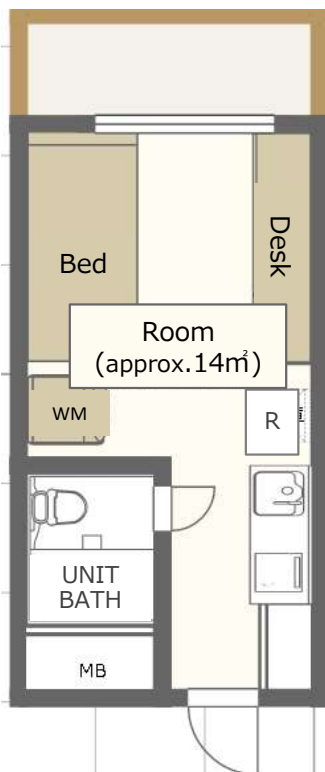

VOICES OF DORM RESIDENTS



We can easily communicate within the dorm, and living in the same dormitory as everyone else is very reassuring.

The rooms are very nice, and the furniture and appliances are provided, which is very helpful!

